

序号	品名	材质
①	1.25-卧式WTB胶芯	PA6T UL94V-0 米黄色
②	1.25-卧式WTB端子	铜合金/表面镀锡
③	1.25-卧式WTB焊片	铜合金/表面镀锡

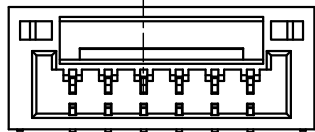

2~6 Pin

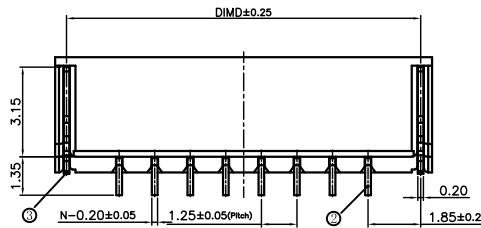
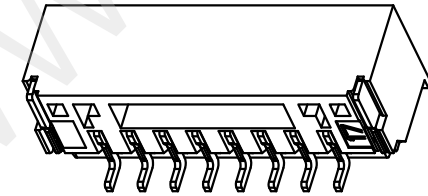
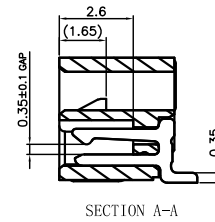
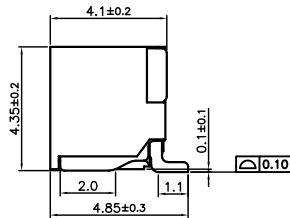
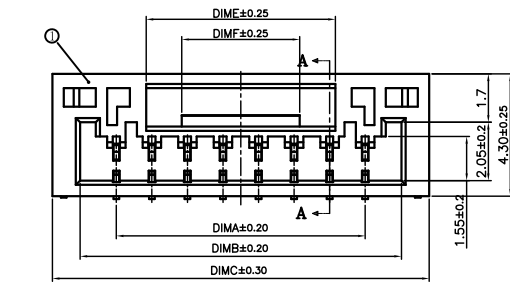
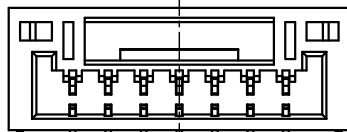

7 Pin

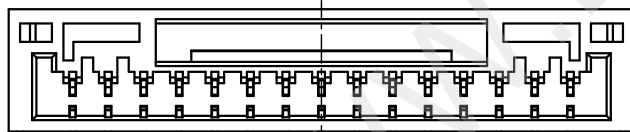

14~18 Pin

适用线路板

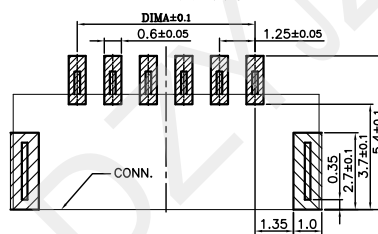

技术指标:

1. 塑件表面应光洁、无毛边、无明显收缩、缺陷、裂纹等现象。
2. 温度范围: -25° C~85° C.
3. 额定电压: 50V AC,DC.
4. 耐电压: 500V AC/minute.
5. 接触电阻: ≤0.02Ω.
6. 绝缘电阻: ≥100MΩ.
7. 额定电流: 1A AC, DC.

CKT	A	B	C	D	E	F
2	1.25	3.80	5.75	4.95	2.15	0.75
3	2.50	5.05	7.00	6.20	3.40	2.00
4	3.75	6.30	8.25	7.45	4.65	3.25
5	5.00	7.55	9.50	8.70	5.90	4.50
6	6.25	8.80	10.75	9.95	7.15	5.75
7	7.50	10.05	12.00	11.20	8.40	7.00
8	8.75	11.30	13.25	12.45	9.65	8.25
9	10.00	12.55	14.50	13.70	10.90	9.50
10	11.25	13.80	15.75	14.95	12.15	10.75
11	12.50	15.05	17.00	16.20	13.40	12.00
12	13.75	16.30	18.25	17.45	14.65	13.25
13	15.00	17.55	19.50	18.70	15.90	14.50
14	16.25	18.80	20.75	19.95	17.15	15.75
15	17.50	20.05	22.00	21.20	18.40	17.00
16	18.75	21.30	23.25	22.45	19.65	18.25
17	20.00	22.55	24.50	23.70	20.90	19.50
18	21.25	23.80	25.75	24.95	22.15	20.75



深圳市华宇创精密电子有限公司

TOLERANCE: X.X ±0.30 X.XX ±0.25 X.XXX ±0.15 X' ±2' X.X' ±0.5'	DRAWN BY : 陈一鸣	DATE : 2014-02-23	PART NAME: GH 1.25 卧贴
	CHECKED BY: 马跃	DATE : 2014-02-23	PART NO. HVC248-WFN-125
UNIT: mm [inch] SCALE: 1:1 SIZE: A4	APPROVED BY: 邱敏	DATE : 2014-02-23	DRAW NO.: HVC-2310062057
			SHEET NO. 1 OF 1